



Anderson Mall is a regional mall featuring Belk, Goody's, JCPenney and Sears, and over 70 specialty stores. The mall serves 10 counties and is the only regional mall within a 30-mile radius. Anderson Mall is located in one of the South's major growth areas and is the nearest mall to Clemson University.

TRADE-AREA PROFILE

The majority of the people within Anderson Mall's trade area are married (54%) and the workforce is predominantly blue collar. 48% of the trade-area households have incomes of at least \$35,000.

Anderson Mall

3131 N. Main St, Anderson, SC 29621

EYE™ ©. EYE Mall Media (USA), LLC. SALES: 1 877 393 6671.

Sources: SPG Research 5/09. Trade-area demographic information created with Pitney Bowes MapInfo (2008).

PROPERTY FACTS

MALL TYPE | Regional

LEVELS | 1

GROSS LEASABLE AREA | 671,000 sf

FOOD COURT | Yes

THEATER | No

ANCHORS | 4: JCPenney, Belk, Sears, Goody's

STORES | 70+: Aeropostale, American Eagle, Outfitters, Bath & Body Works, Champs, Claire's, Express, Foot Locker, FootAction USA, GameStop, Hallmark, Hollister Co., Hot Topic, IHOP, Journeys, Kay Jewelers, Lane Bryant, LensCrafters, New York & Co., PacSun, Radio Shack, Victoria's Secret, Wet Seal,

GENDER | Male 48.9%, Female 51.1%

TRADE-AREA POPULATION | 303,119

AVERAGE ANNUAL HH INCOME | \$53,830

TOP FOUR LIFESTYLE SEGMENTATION GROUPS

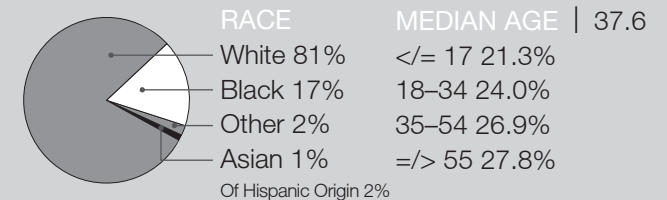
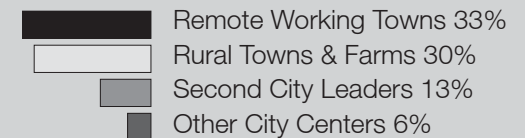

MEDIAN AGE | 37.6

<= 17 21.3%

18-34 24.0%

35-54 26.9%

=/> 55 27.8%

SIMON® | PROPERTY GROUP

eye™

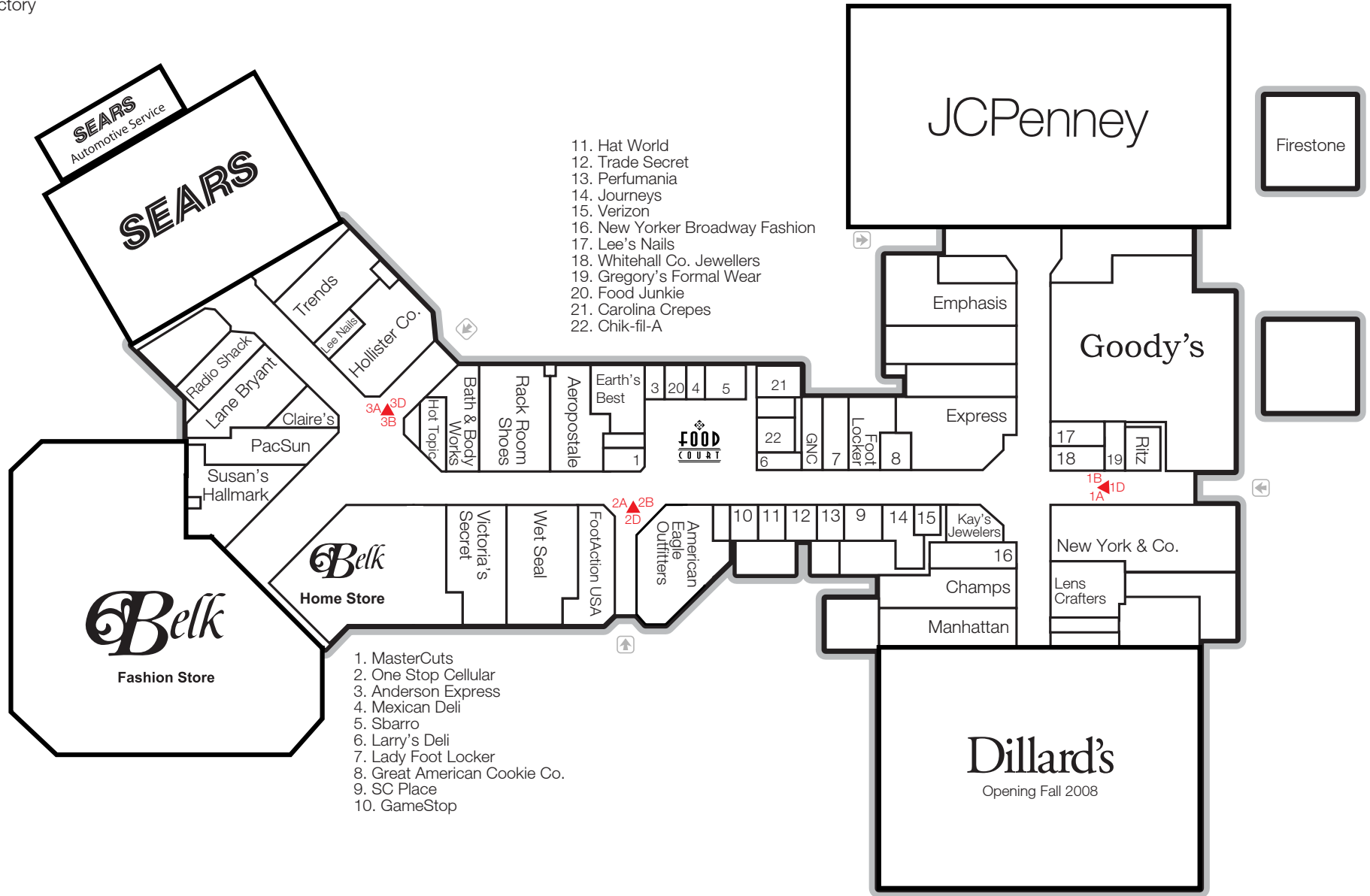

Anderson Mall

3131 N. Main St, Anderson, SC 29621



South Carolina

SALES 1 877 393 6671 WWW.EYECORP.COM

Eye Shop. EYE™ ©.

