



Brunswick Square is conveniently located in the heart of central New Jersey on the heavily traveled State Route 18. This newly renovated regional mall is anchored by Macy's and JCPenney, and features an assortment of exciting specialty retailers, eateries and entertainment venues.

### TRADE-AREA PROFILE

The majority of the people within Brunswick Square's trade area are married (54%) and the workforce is predominantly white collar. 43% of the trade-area households have incomes of at least \$75,000. 59% of the residents have at least some college education.

## Brunswick Square

755 State Rte 18, East Brunswick, NJ 08816

EYE™ ©. EYE Mall Media (USA), LLC. SALES: 1 877 393 6671.

Sources: SPG Research 5/09. Trade-area demographic information created with Pitney Bowes MapInfo (2008).

## PROPERTY FACTS

MALL TYPE | Regional

LEVELS | 1

GROSS LEASABLE AREA | 765,000 sf

FOOD COURT | No

THEATER | Yes

ANCHORS | 2: JCPenney, Macy's

STORES | 80+: Aeropostale, American Eagle Outfitters, Auntie Anne's, Bath & Body Works, Champs Sports, Charlotte Russe, The Children's Place, Express, Footaction USA, Forever 21, fye, GNC, Hollister Co., Kay Jewelers, New York & Co., Old Navy, PacSun, Radio Shack, Ruby Tuesday, Victoria's Secret

GENDER | Male 48.7%, Female 51.3%

TRADE-AREA POPULATION | 344,525

AVERAGE ANNUAL HH INCOME | \$97,916

### TOP FOUR LIFESTYLE SEGMENTATION GROUPS

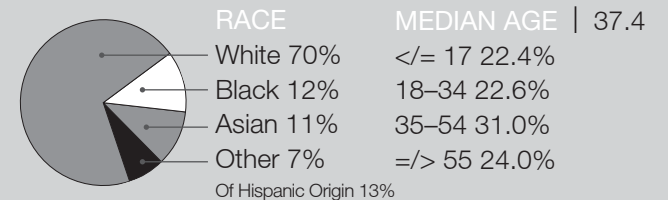
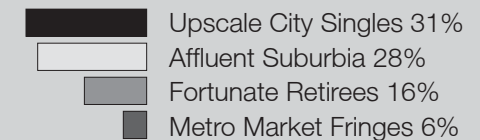

SIMON® | PROPERTY GROUP

eye™

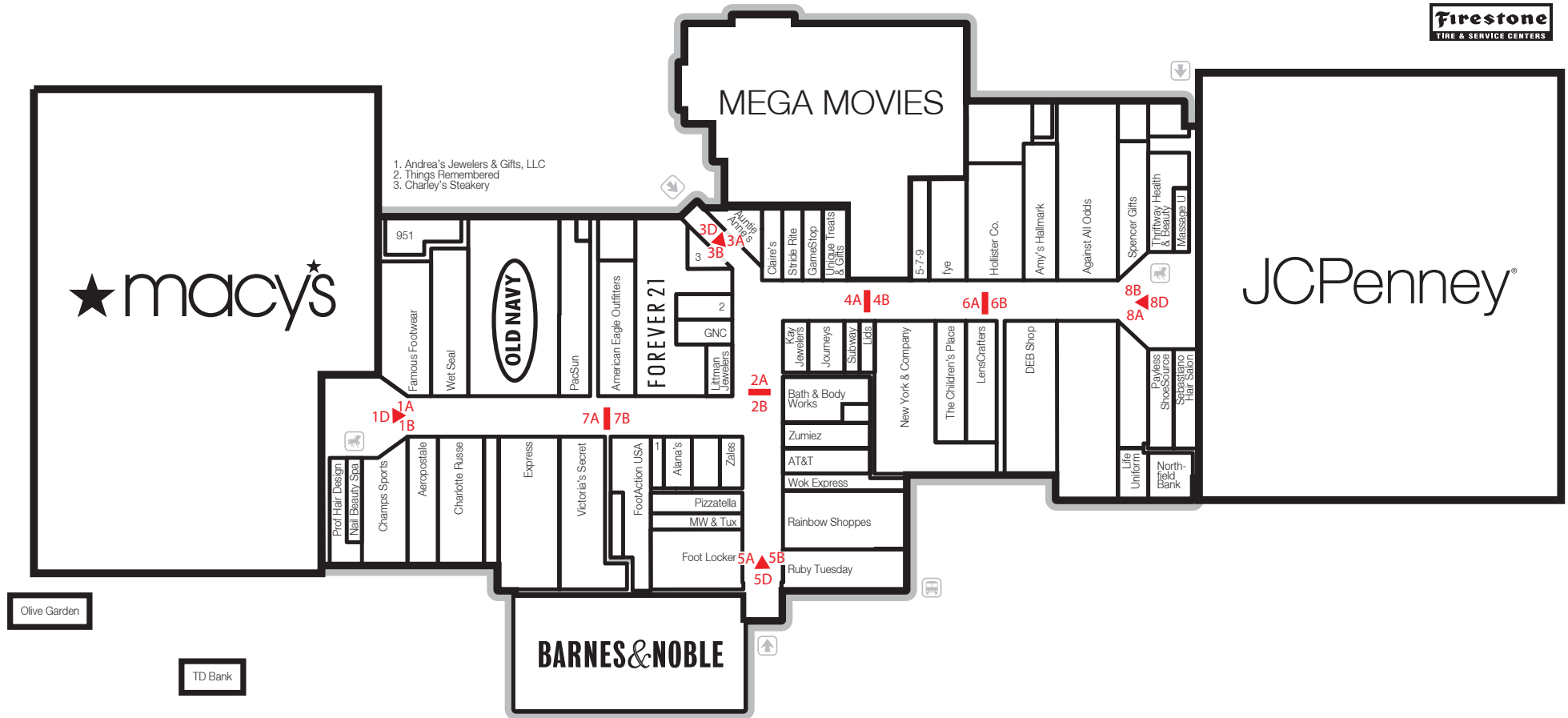

# Brunswick Square

755 State Route 18, East Brunswick, NJ 08816



# New Jersey

**SALES 1 877 393 6671** [WWW.EYECORP.COM](http://WWW.EYECORP.COM)

Eye Shop. EYE™ ©.

