



Castleton Square is Indiana's largest mall. The recently renovated super-regional mall is the dominant mall on Indianapolis's affluent northside. The mall's trade area will continue to experience significant population and income growth as Hamilton County continues to develop (the fastest growing county in the state). Castleton Square features Dick's Sporting Goods, JCPenney, Macy's, Sears and Von Maur, and over 120 specialty stores.

TRADE-AREA PROFILE

The majority of the people within Castleton Square's trade area are married (56%) and the workforce is predominantly white collar. 49% of the trade-area households have incomes of at least \$50,000.

Castleton Square

6020 W. 82nd St, Indianapolis, IN 46250

EYE™ ©. EYE Mall Media (USA), LLC. SALES: 1 877 393 6671.

Sources: SPG Research 5/09. Trade-area demographic information created with Pitney Bowes MapInfo (2008).

PROPERTY FACTS

MALL TYPE | Regional

LEVELS | 1

GROSS LEASABLE AREA | 1,381,000 sf

FOOD COURT | Yes

THEATER | Yes

ANCHORS | 5: Dick's Sporting Goods, JCPenney
Macy's, Sears, Von Maur

STORES | 120+: AMC 14 Theatre, American Eagle Outfitters, Borders, Build-A-Bear Workshop®, The Children's Place, Christopher & Banks, Crazy 8, Fossil, Gap, H&M, Hollister Co., Houlihan's, Kay Jewelers, The Limited, LOFT, shi by Journeys, Swarovski, Stir Crazy, T.G.I. Friday's, Victoria's Secret

GENDER | Male 48.4%, Female 51.6%

TRADE-AREA POPULATION | 670,865

AVERAGE ANNUAL HH INCOME | \$80,985

TOP FOUR LIFESTYLE SEGMENTATION GROUPS

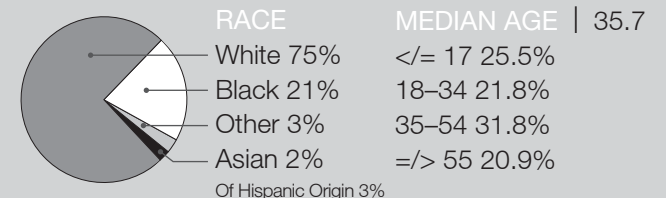
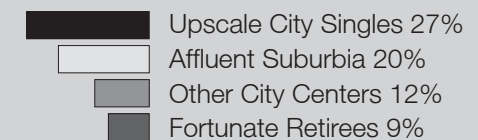

SIMON® | PROPERTY GROUP

eye™

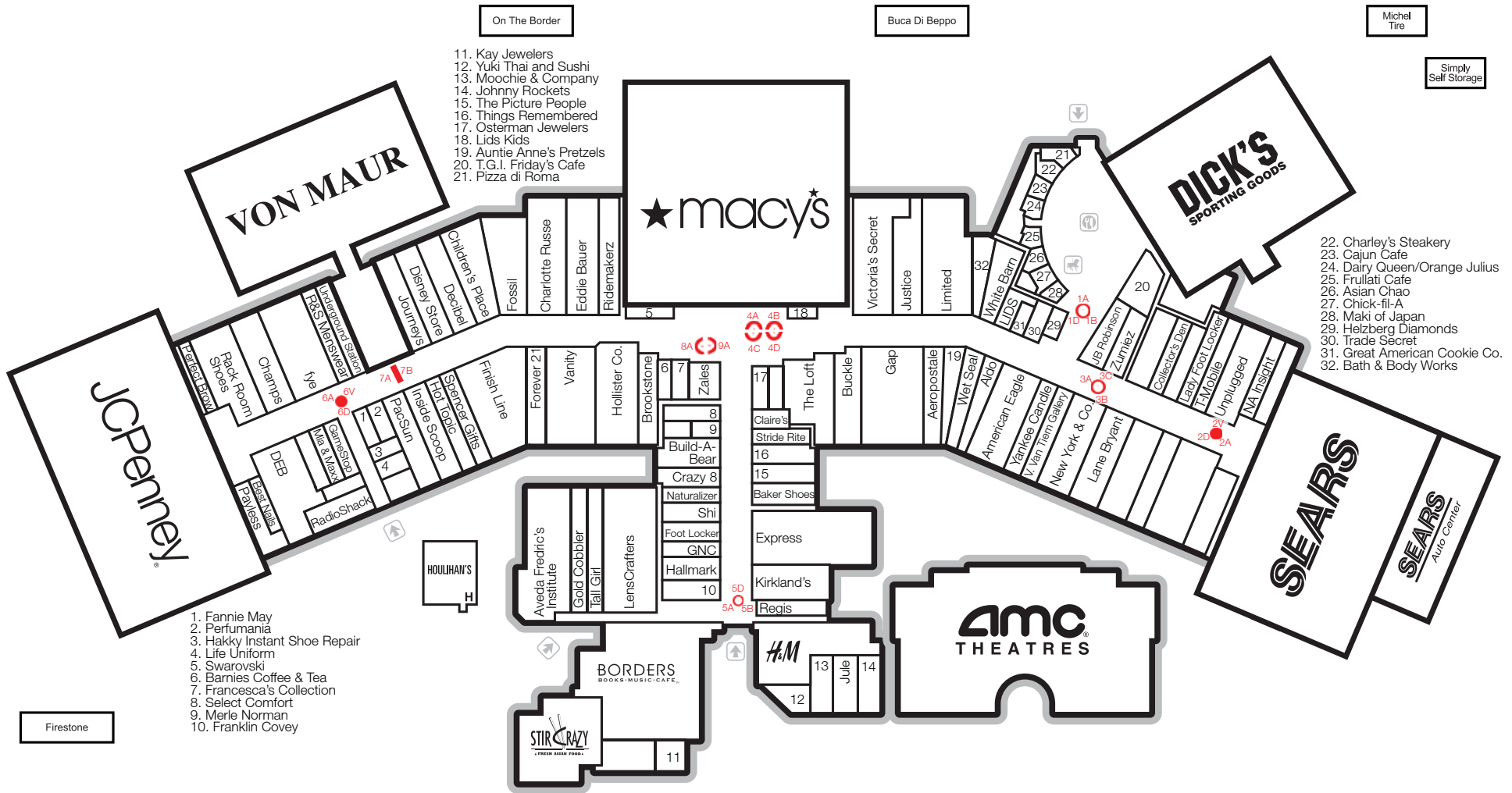

Castleton Square

6020 W. 82nd St, Indianapolis, IN 46250

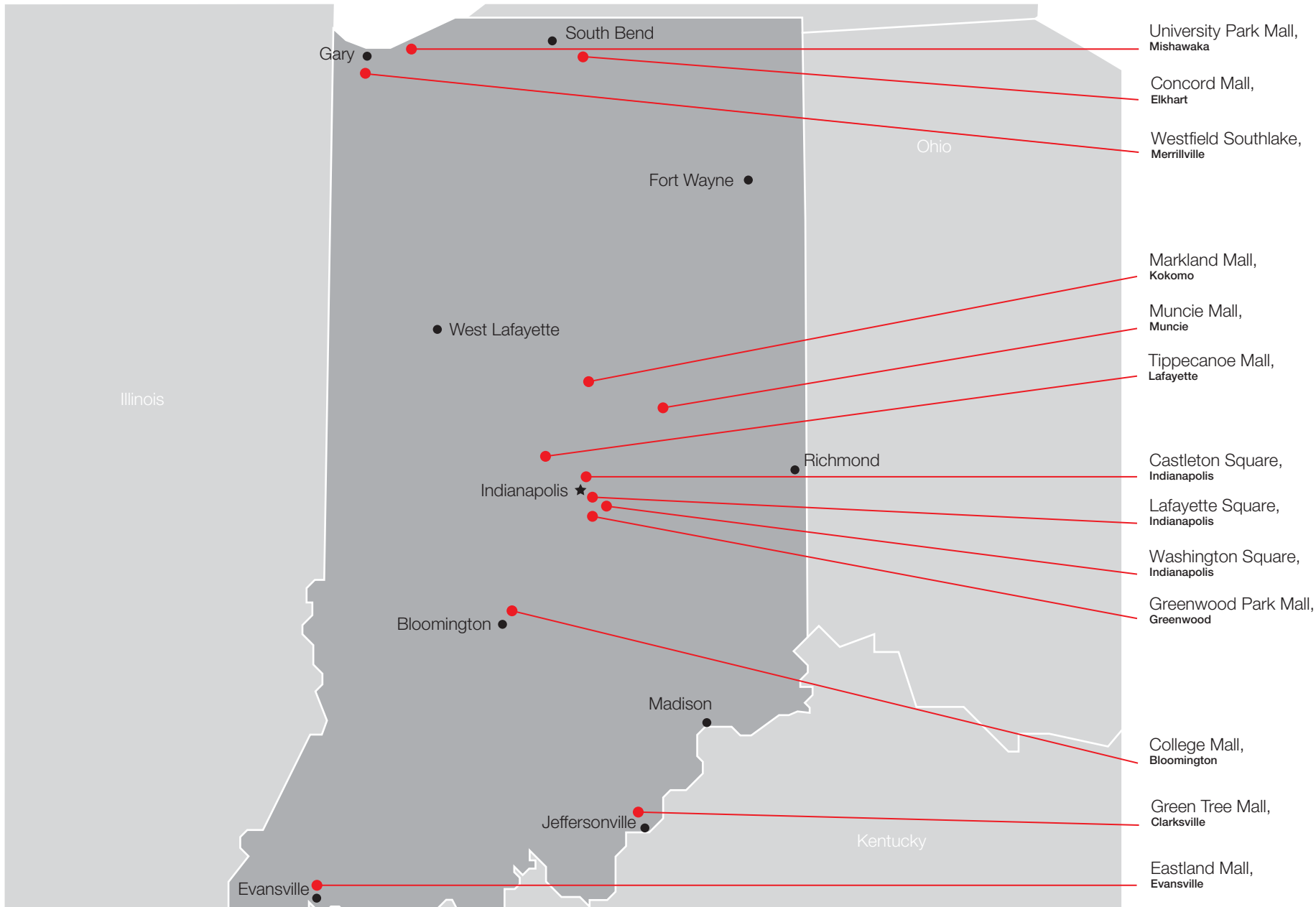

Indiana

SALES 1 877 393 6671 WWW.EYECORP.COM

Eye Shop. EYE™ ©.

