



Chautauqua Mall features Bon-Ton, JCPenney and Sears, and over 45 specialty stores. The regional mall is the largest mall between Buffalo, New York and Erie, PA, and the only mall in Chautauqua County. Chautauqua Mall is easily accessed from I-86 in Lakewood, New York.

TRADE-AREA PROFILE

The majority of the people within Chautauqua Mall's trade area are married (58%) and the workforce is predominantly blue collar. 51% of the trade-area households have incomes of at least \$35,000.

Chautauqua Mall

318 E. Fairmount Ave, Lakewood, NY 14750

EYE™ ©. EYE Mall Media (USA), LLC. SALES: 1 877 393 6671.

Sources: SPG Research 5/09. Trade-area demographic information created with Pitney Bowes MapInfo (2008).

PROPERTY FACTS

MALL TYPE | Regional

LEVELS | 1

GROSS LEASABLE AREA | 432,000 sf

FOOD COURT | Yes

THEATER | Yes

ANCHORS | 3: Bon-Ton, JCPenney, Sears

STORES | 45+: Aeropostale, American Eagle Outfitters, Bath & Body Works, Christopher & Banks, C.J. Banks, Claire's, fye, GameStop, GNC, Hot Topic, Kay Jewelers, OfficeMax, Old Navy, PacSun, Victoria's Secret, Waldenbooks, Zales Jewelers

GENDER | Male 49.0%, Female 51.0%

TRADE-AREA POPULATION | 112,324

AVERAGE ANNUAL HH INCOME | \$57,879

TOP FOUR LIFESTYLE SEGMENTATION GROUPS

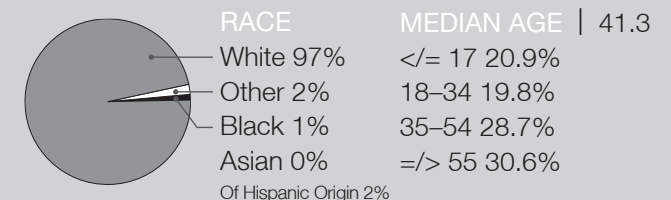
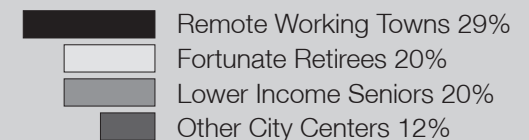

SIMON® | PROPERTY GROUP



d – directory

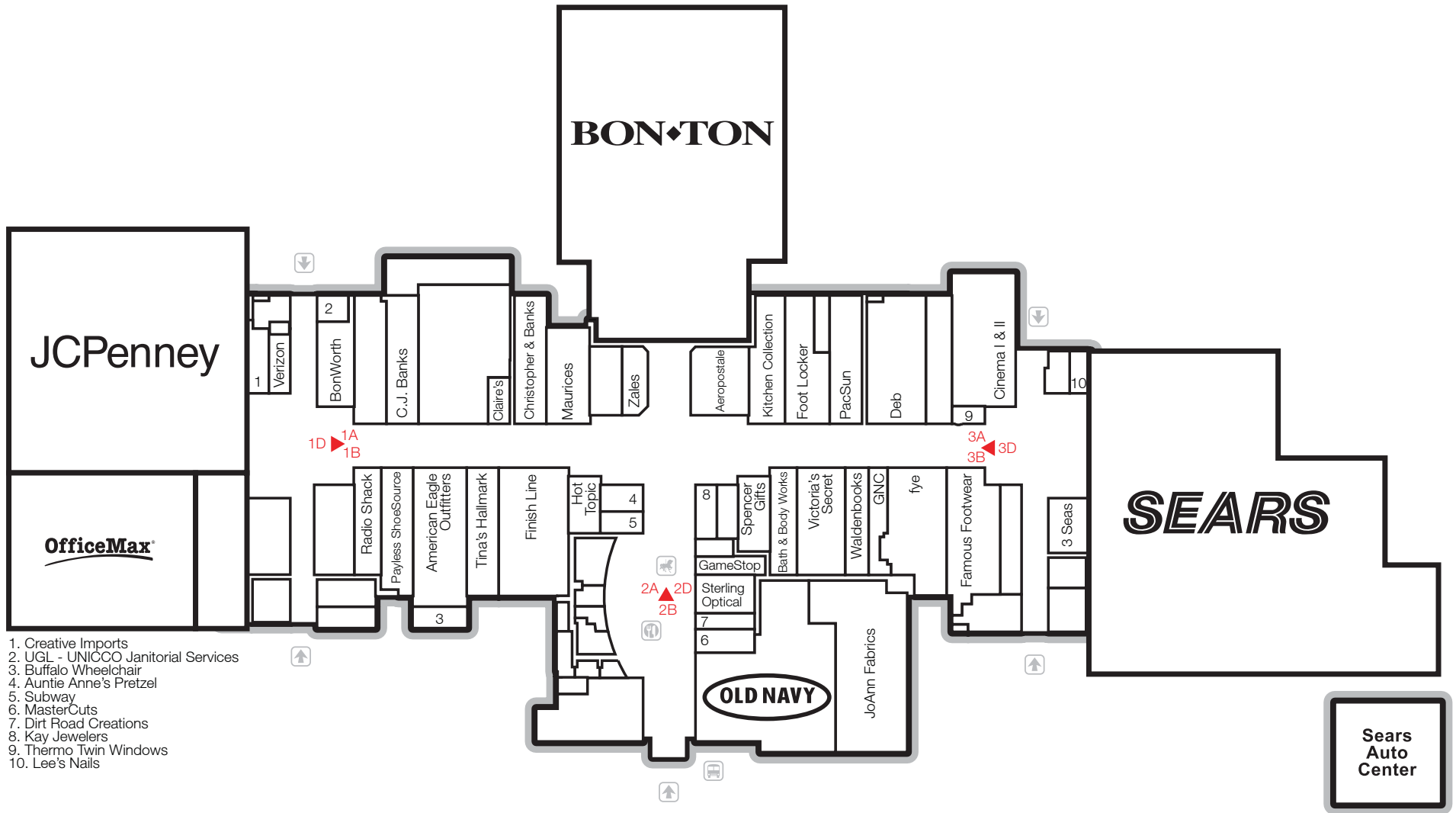

Chautauqua Mall

318 E. Fairmount Ave, Lakewood, NY 14750

EYE™ ©. EYE Mall Media (USA), LLC. SALES: 1 877 393 6671



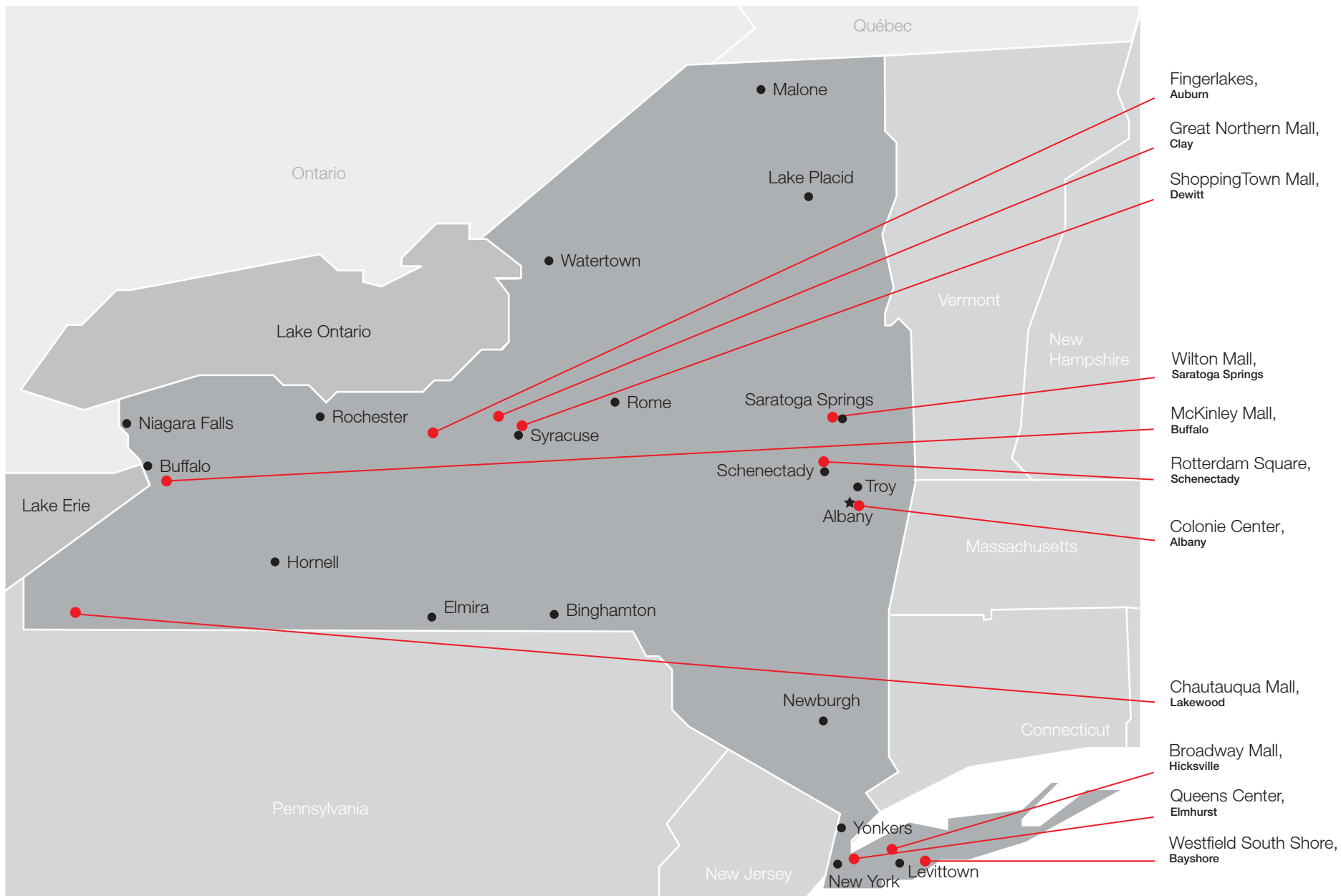

- Fingerlakes, Auburn
- Great Northern Mall, Clay
- ShoppingTown Mall, Dewitt
- Wilton Mall, Saratoga Springs
- McKinley Mall, Buffalo
- Rotterdam Square, Schenectady
- Colonie Center, Albany
- Chautauqua Mall, Lakewood
- Broadway Mall, Hicksville
- Queens Center, Elmhurst
- Westfield South Shore, Bayshore

New York

SALES 1 877 393 6671 WWW.EYECORP.COM

Eye Shop. EYE™ ©.

